

CPO Area Map: CPO2 & CPO2a overlaid on CPO1 decant

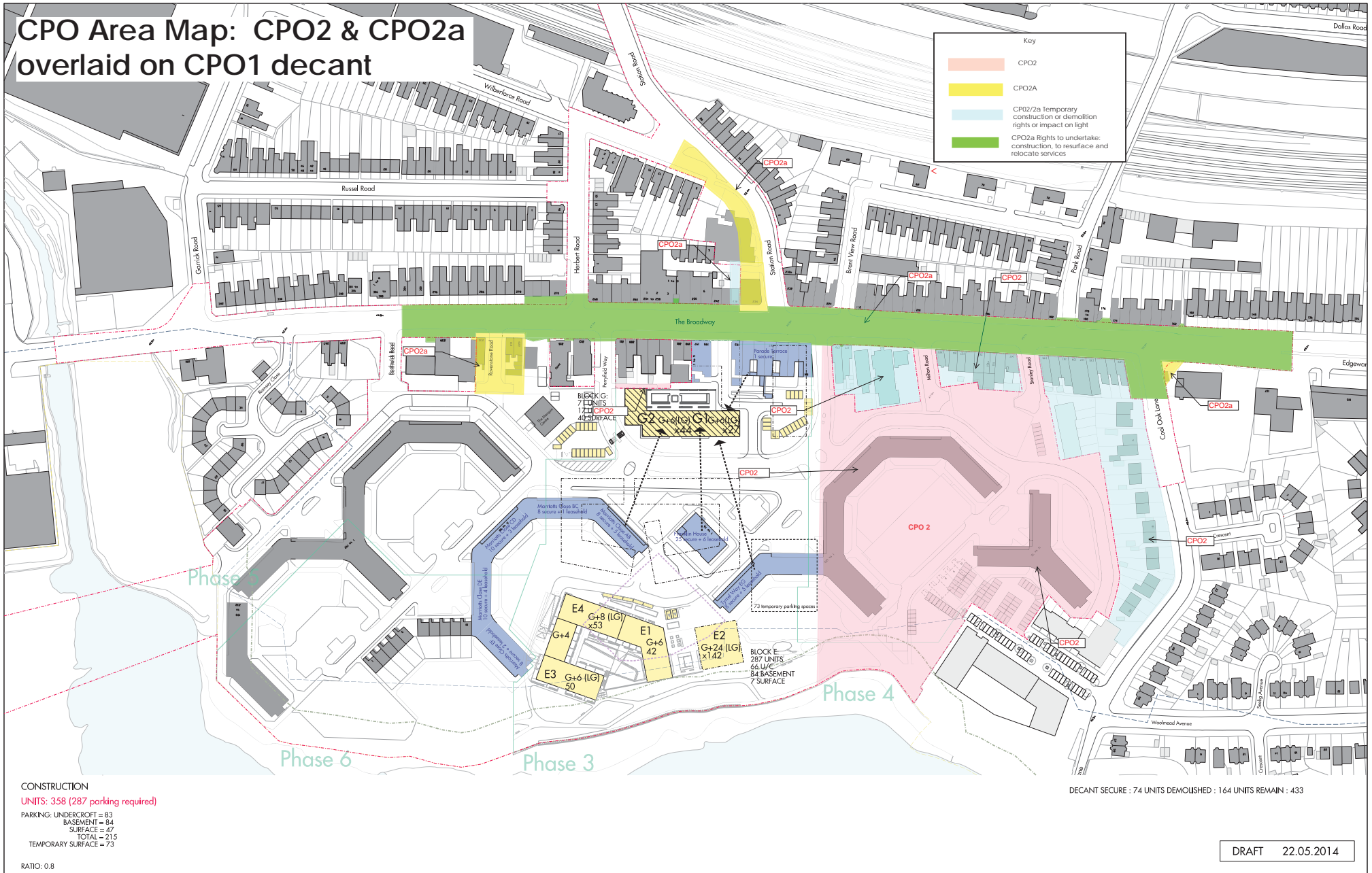

Key

- CPO2
- CPO2A
- CPO2/2a Temporary construction or demolition rights or impact on light
- CPO2a Rights to undertake construction, to resurface and relocate services

CONSTRUCTION
UNITS: 358 (287 parking required)
 PARKING: UNDERCROFT = 83
 BASEMENT = 84
 SURFACE = 47
 TOTAL = 215
 TEMPORARY SURFACE = 73

DECANT SECURE : 74 UNITS DEMOLISHED : 164 UNITS REMAIN : 433

DRAFT 22.05.2014

RATIO: 0.8

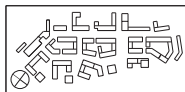

Do not scale from this drawing. Use figured dimensions only. Figured dimensions are in millimetres. All levels are in metres. All dimensions and levels shall be verified on site before proceeding with works. Detailed site survey to be carried out to verify positions and level relationships with site features and existing survey. The architect must be notified of any discrepancy. Where building components are described in the specification as contractor designed, "construction" information relating to those components on this drawing represents design intent only.

LEGEND

- Existing Sewer Line
- Site No Build Zone
- Planning Application Line
- Catalyst Site
- Phasing Boundary
- Affordable Units
- Units to be demolished following decant

3A	4B	5A	6A
3B	4C	5B	6B
3C	4A		

REV	DATE	DESCRIPTION	REV	DATE	DESCRIPTION

Allies and Morrison
 85 Southwark Street
 London SE1 0HQ
 020 7921 0100
 020 7921 0101
 info@alliesandmorrison.co.uk
 A&M JOB NO: 716

WEST HENDON MASTERPLAN
 SITE PLAN
 PHASE 3A
 716_00_SK_120
 SCALE: 1:1000 @A1 2000 @A3

Revision